

## Fan control unit

	Fan control - complete	see table
4	Plastic tube - Ø 6/4 mm	103 144#
6	Locknut - M20x1.5 mm	266 035
7	Locknut - M40x1.5 mm	265 357
8	Cable connection - M20/1/8-15 mm	266 019
9	Cable connection - M40/1/28.5-33 mm	265 349
10	Elbow joint - 6-1/8"-6 mm	245 950
11	Elbow joint - 1/8"a, Ø 6 mm	254 061
12	Connection fitting - Ø 8/6-6/4 mm, M12x1 mm	1005 084
13	Nut - M12x1-Ø 8 mm	263 079
14	Switch - 0,75-5,6 kPa	243 744
	Switch - 1.25-11.0 kPa	243 752
15	Pressure gauge - 0-2.5 kPa, differential pressure	243 760
	Pressure gauge - 0-5.0 kPa, differential pressure	243 779
16	Pressure gauge - 0-5.0 kPa, differential pressure	243 779
	Pressure gauge - 0-8.0 kPa, differential pressure	251 844
17	Nut with kink protection - M12x1-Ø 8 mm	201 316
20	Main switch - see corresponding wiring diagram	
21	Connecting socket/plug - see corresponding wiring diagram	

# Wearing part

Order number	Motor performance (kW)	Pressure indicator (kPa)	
		Filter (pos. 15)	Fan (pos. 16)
1004 358	5.5	5.0	8.0
1004 359	7.5	5.0	8.0
1004 937	11	2.5	5.0
1004 360	11	5.0	8.0
1004 938	15	2.5	5.0
1004 361	15	5.0	8.0
1002 178	22	2.5	5.0
1002 205	22	5.0	8.0
1002 179	30	2.5	5.0
1002 174	30	5.0	8.0
1002 180	37	2.5	5.0
1002 175	37	5.0	8.0
1002 176	45	5.0	8.0
1002 177	55	5.0	8.0

# Fan control unit

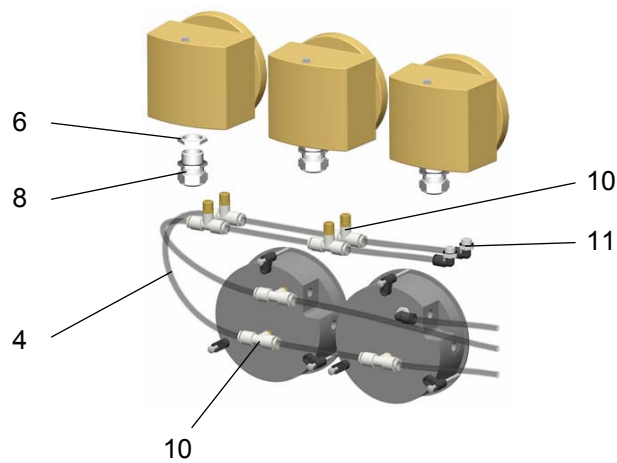
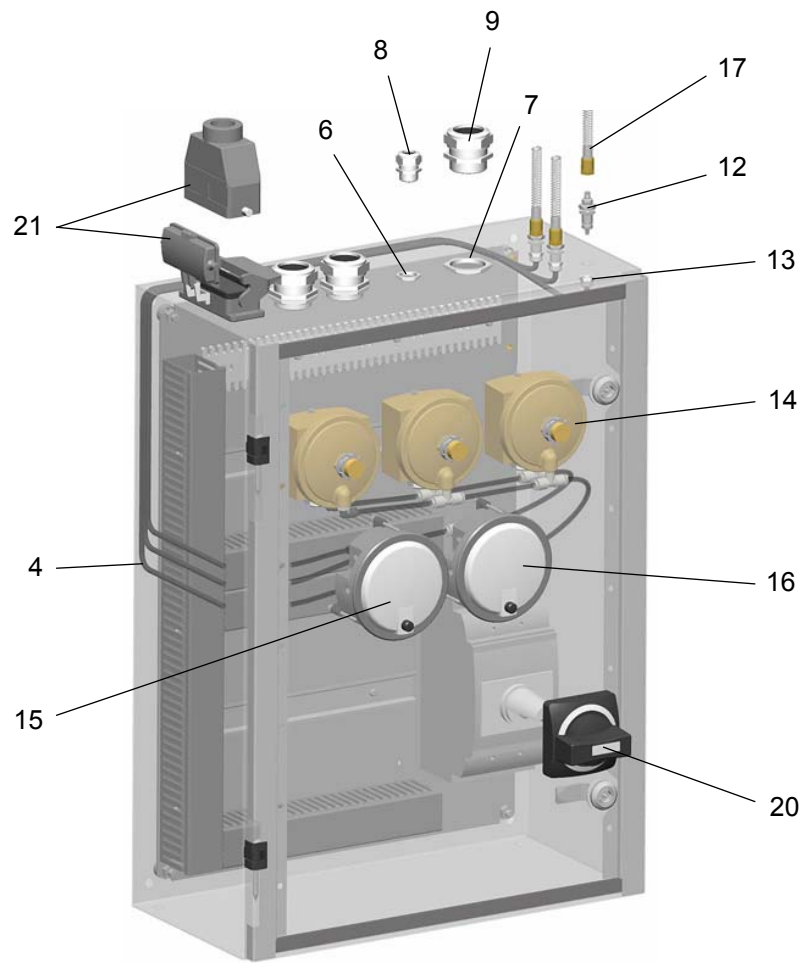

*MagicCylinder II - fan control unit*